

STAND-UP CHARACTER: WOLF BOSS

ASSEMBLY INSTRUCTIONS



YOU WILL NEED:

- Metal-edged ruler
- Butter knife
- Scissors or craft knife
- Cutting mat (optional)
- Multipurpose glue



GETTING STARTED

- 1** Score all the pieces: Using a ruler as a guide, run the back side of a butter knife firmly along all dashed and dotted lines.



- 2** Using scissors or a craft knife and cutting mat, cut out all pieces along solid lines.



- 3** Fold all pieces along score lines, using the folding key below as a reference.



ASSEMBLY

- 4** Glue all tabs on sides of body in place.

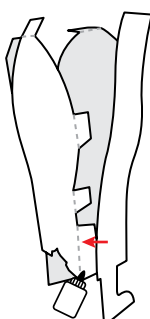
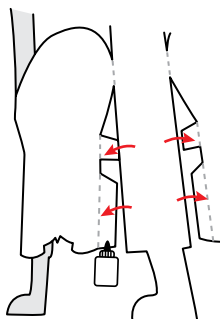

- 5** Bend top body panel down and glue to top tabs and side of body where indicated by artwork.

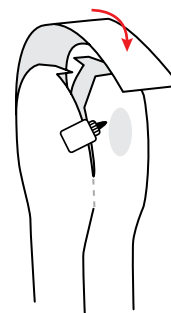

- 6** Tuck tabs at front of head behind the mouth area and glue in place. Glue tabs at back of head together.

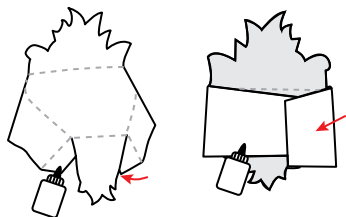

- 7** Attach head to body where indicated by artwork.

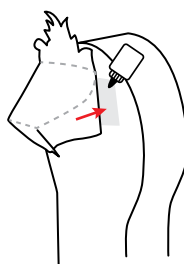

- 8** Assemble arms by gluing tabs in place.



- 9** Attach arms to body where indicated by artwork.

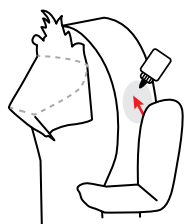

- 10** Fold tail piece in half and glue together. Cut out tail along inner white line. Insert tail into slit on back of body.

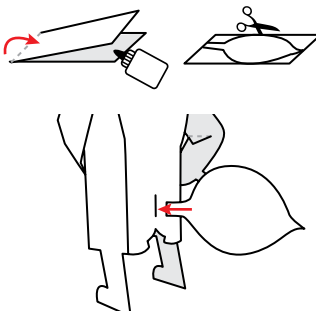

- 11** You're done!



STAND-UP CHARACTER: WOLF BOSS



BODY

HEAD

RIGHT ARM

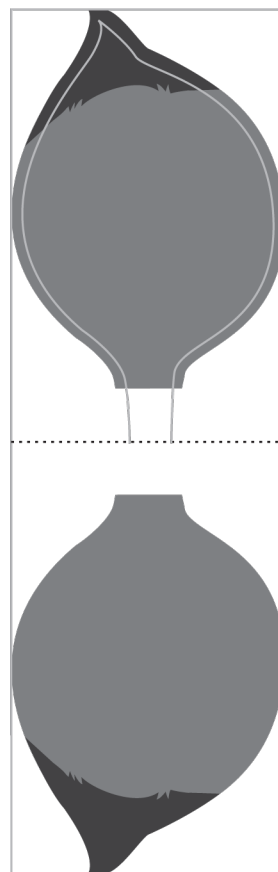
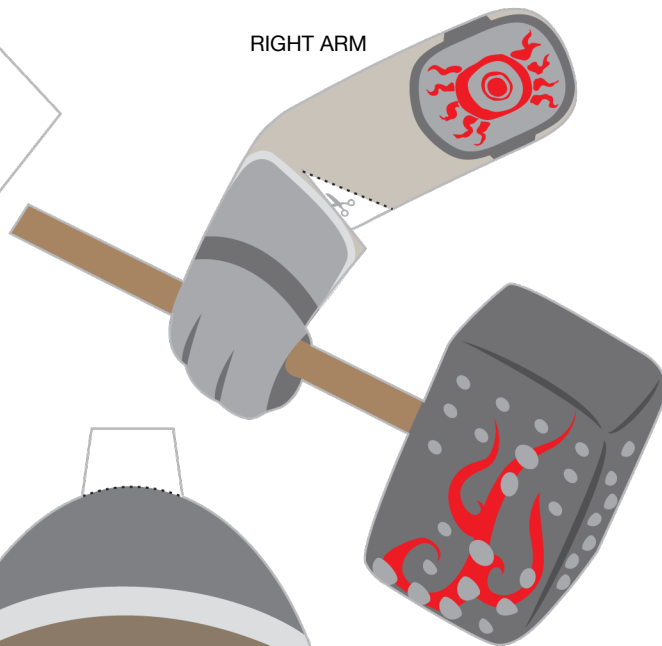
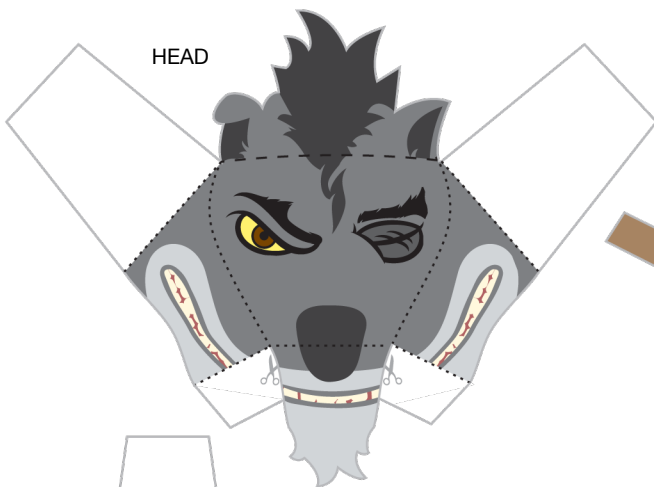
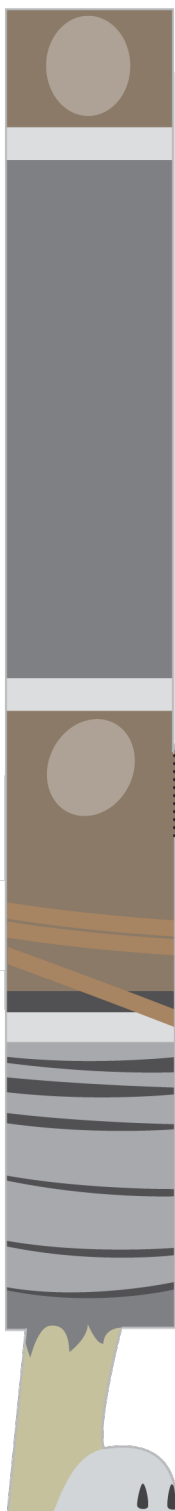

TAIL

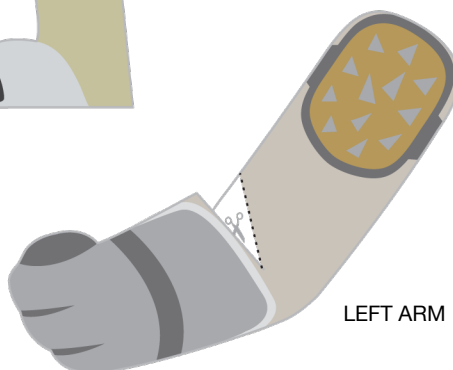

LEFT ARM